

# METACRYLICS

## ACRYLIC ROOF TOP PENETRATION ROOF DETAILS

ACRYLIC  
ROOF  
DETAILS

SEAL:

### DRAWING INDEX:

- C-01 - COVER PAGE & DRAWING INDEX SHEET
- A-01 - WALKING PAD
- A-02 - METAL PARAPET CAP AND BASE FLASHING
- A-03 - SKYLIGHT
- A-04 - PLUMBING VENT
- A-05 - ROOF DRAIN
- A-06 - SCUPPER
- A-07 - CURB
- A-08 - RAISED CURB FOR ROOFTOP EQUIPMENT
- A-09 - BASE FLASHING WITH COUNTER FLASHING
- A-10 - ROOF PERIMETER EDGE
- A-11 - GUTTER
- A-12 - FIELD SEAMS

REV:

JOB NUMBER:

SCALE:

DATE: 09-25-17

DRAWN BY:  
DHALSELL

CHECKED BY:

SHEET:

C-01

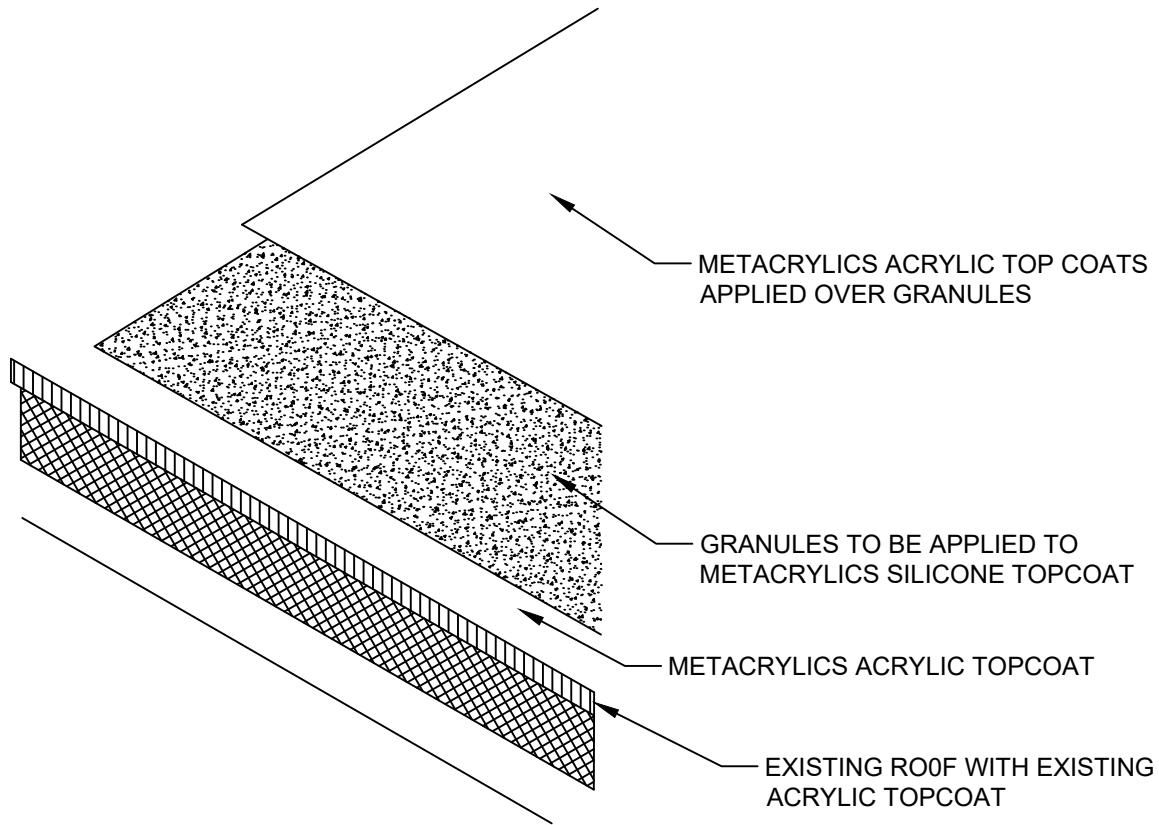

**ACRYLIC  
ROOF  
DETAILS**

SEAL:

REV:

JOB NUMBER:

SCALE:

DATE: 09-25-17

DRAWN BY: DHALSELL

CHECKED BY:

SHEET:  
**A-01**

**WALKING PAD**

ACRYLIC  
ROOF  
DETAILS

SEAL:

REV:

JOB NUMBER:

SCALE:

DATE: 09-25-17

DRAWN BY: DHALSELL

CHECKED BY:

SHEET:

A-02

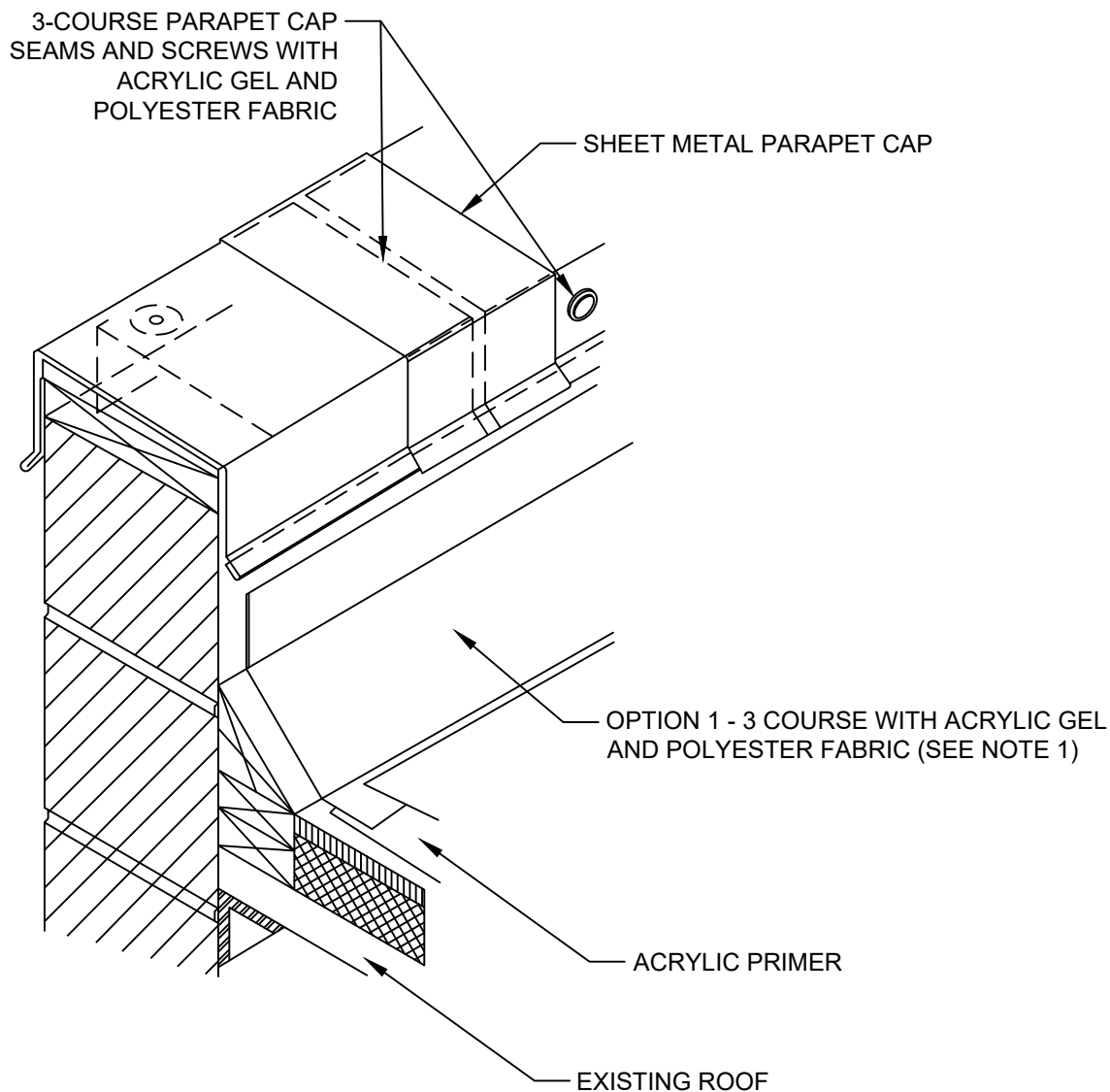

# METAL PARAPET CAP & BASE FLASHING

**NOTES:**

1. THE PRIMER APPLICATION IS REQUIRED BEFORE THE 3-COURSE IS STARTED

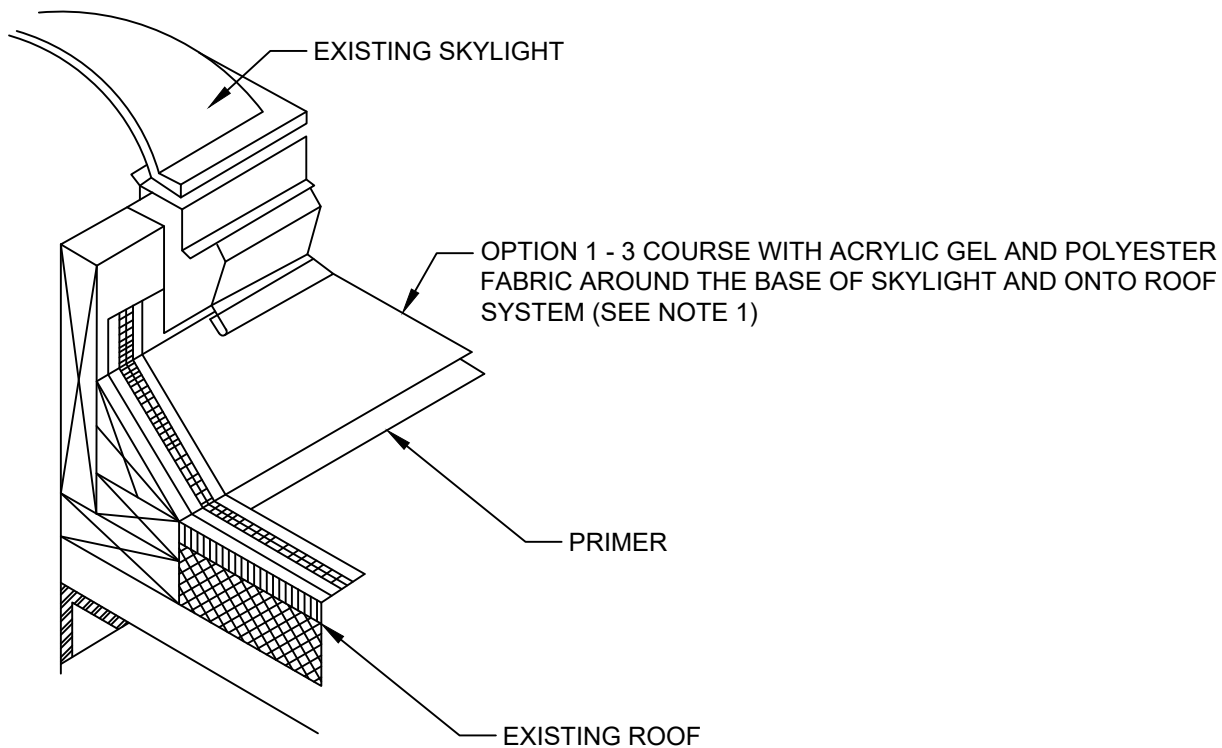

ACRYLIC  
ROOF  
DETAILS

SEAL:

REV:

JOB NUMBER:

SCALE:

DATE: 09-25-17

DRAWN BY: DHALSELL

CHECKED BY:

SHEET:

A-03

# SKYLIGHT

**NOTES:**

1. THE PRIMER APPLICATION IS REQUIRED BEFORE THE 3-COURSING IS STARTED

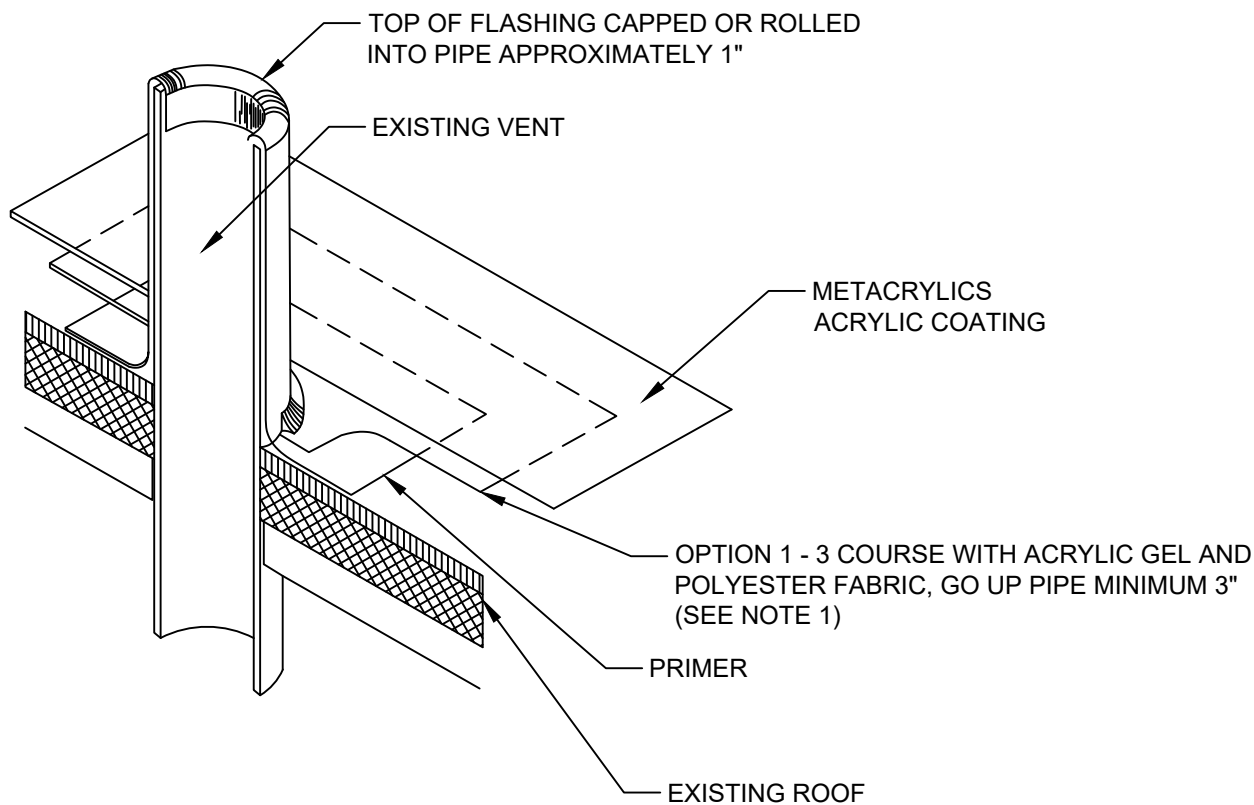

**ACRYLIC ROOF DETAILS**

SEAL:

REV:

JOB NUMBER:

SCALE:

DATE: 09-25-17

DRAWN BY: DHALSELL

CHECKED BY:

SHEET:

**A-04**

**PLUMBING VENT**

**NOTES:**

1. THE PRIMER APPLICATION IS REQUIRED BEFORE THE 3-COURSING IS STARTED

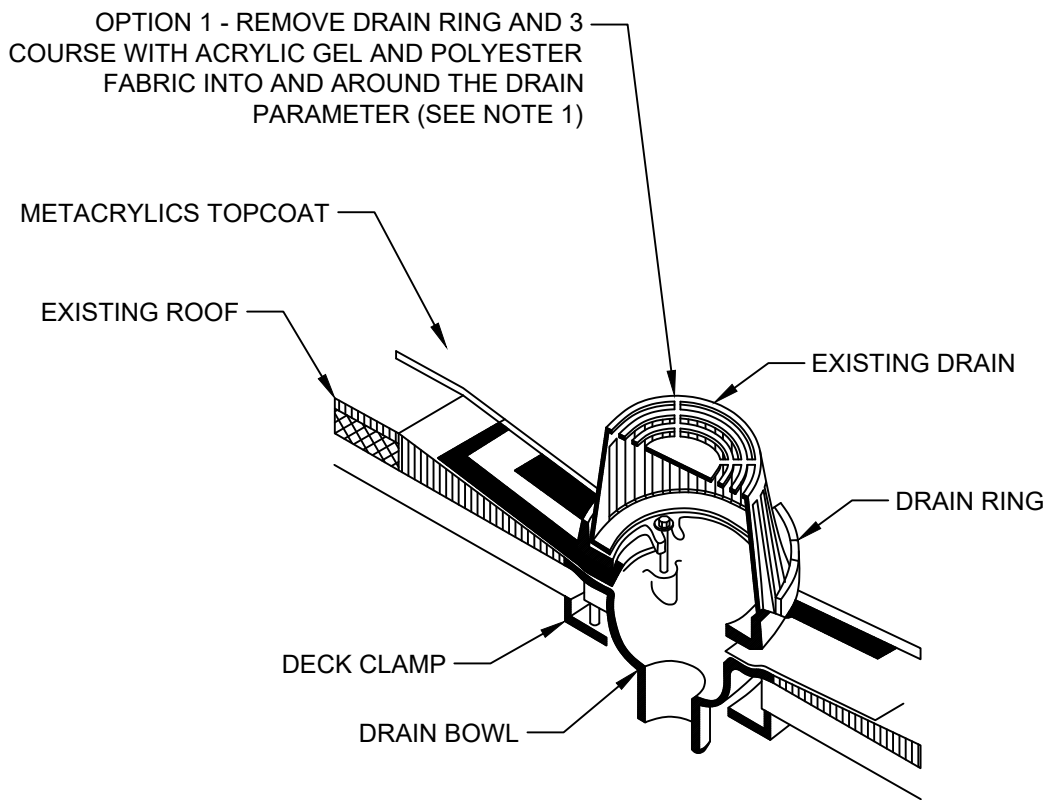

**ACRYLIC  
ROOF  
DETAILS**

SEAL:

REV:

JOB NUMBER:

SCALE:

DATE: 09-25-17

DRAWN BY: DHALSELL

CHECKED BY:

SHEET:

**A-05**

**ROOF DRAIN**

**NOTES:**

1. THE PRIMER APPLICATION IS REQUIRED BEFORE THE 3-COURSING IS STARTED

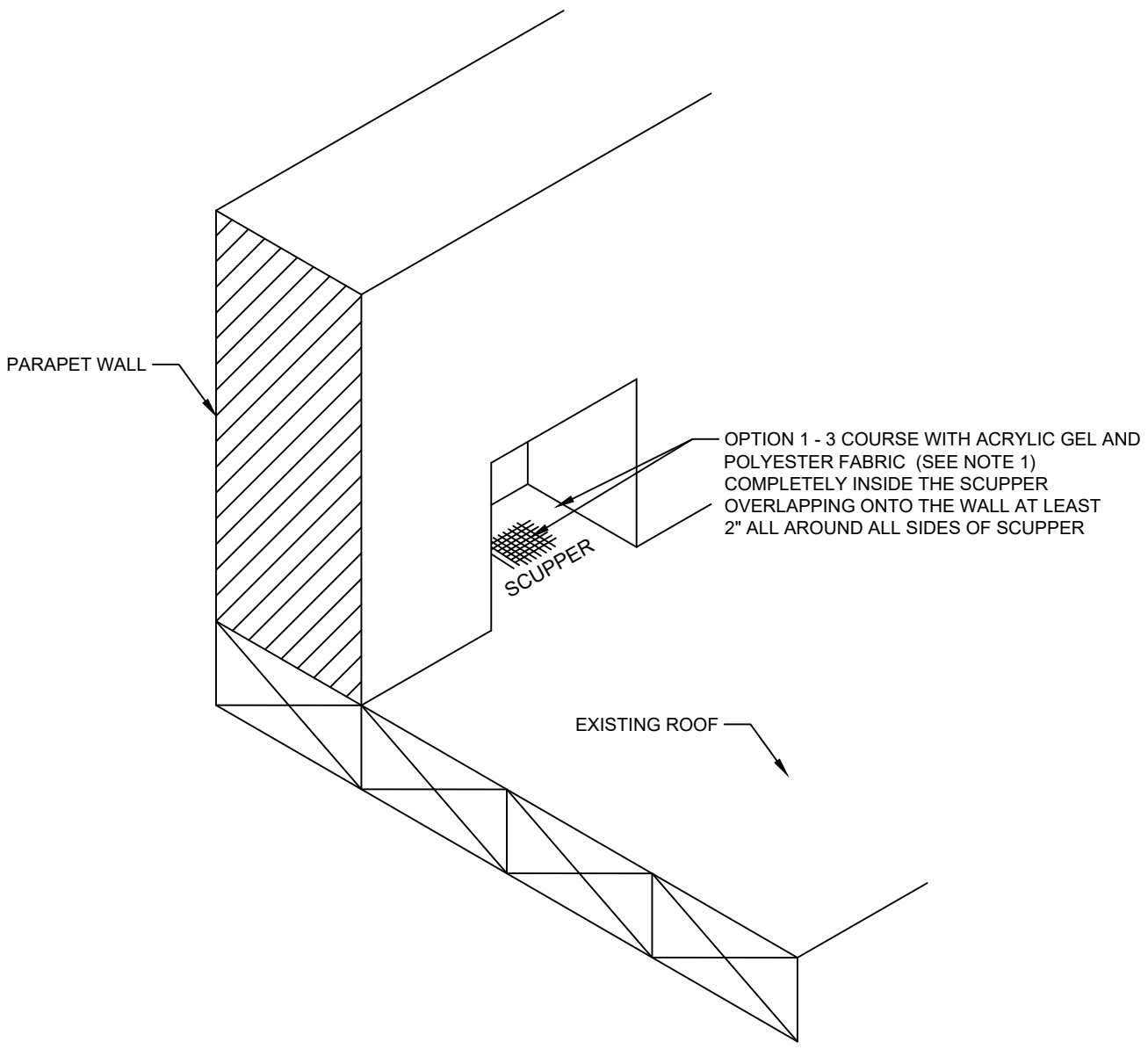

# SCUPPER

## ACRYLIC ROOF DETAILS

SEAL:

REV:

JOB NUMBER:

SCALE:

DATE: 09-25-17

DRAWN BY: DHALSELL

CHECKED BY:

SHEET:  
**A-06**

**NOTES:**

1. THE PRIMER APPLICATION IS REQUIRED BEFORE THE 3-COURSING IS STARTED

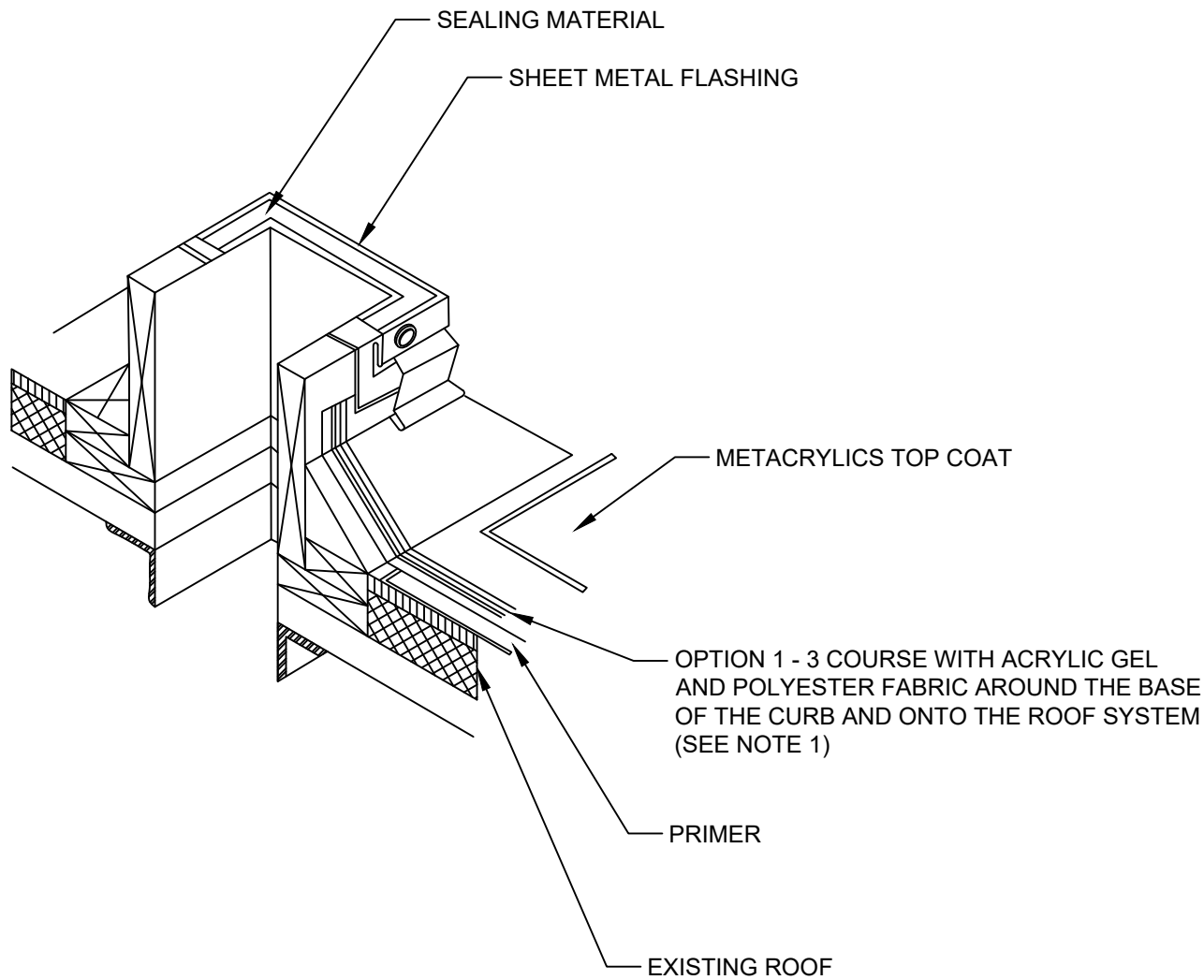

# CURB

**NOTES:**

1. THE PRIMER APPLICATION IS REQUIRED BEFORE THE 3-COURSING IS STARTED

## ACRYLIC ROOF DETAILS

SEAL:

REV:

JOB NUMBER:

SCALE:

DATE: 09-25-17

DRAWN BY: DHALSELL

CHECKED BY:

SHEET:

A-07



OPTION 1 - 3 COURSE WITH ACRYLIC GEL AND POLYESTER FABRIC (SEE NOTE 1) OVERLAPPED JOINTS INCLUDING PERIMETER OF METAL WITH ACRYLIC GEL & FABRIC

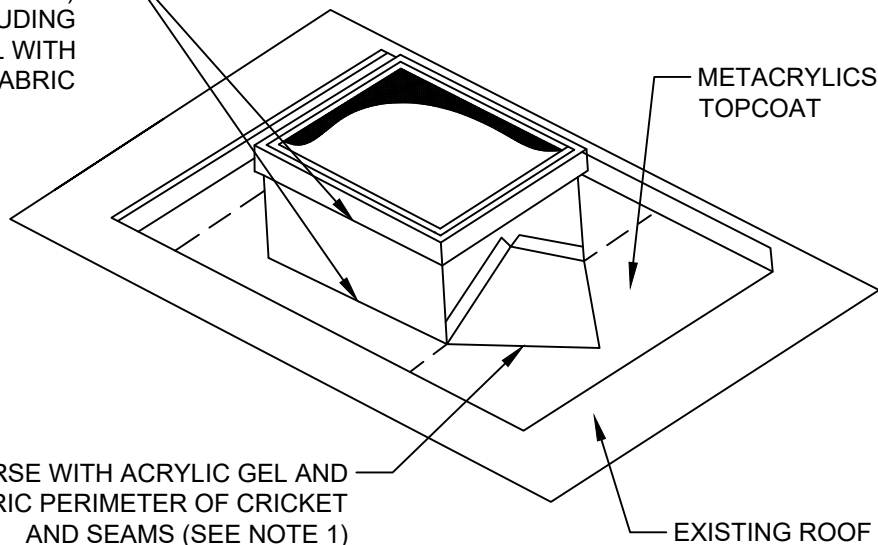

OPTION 1 - 3 COURSE WITH ACRYLIC GEL AND POLYESTER FABRIC PERIMETER OF CRICKET AND SEAMS (SEE NOTE 1)

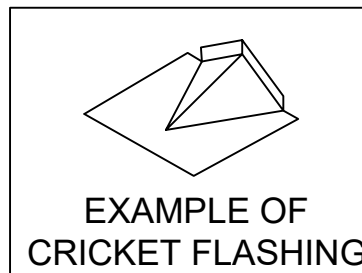

**ACRYLIC ROOF DETAILS**

SEAL:

REV:

JOB NUMBER:

SCALE:

DATE: 09-25-17

DRAWN BY: DHALSELL

CHECKED BY:

SHEET:

**A-08**

# RAISED CURB FOR ROOFTOP EQUIPMENT

**NOTES:**

1. THE PRIMER APPLICATION IS REQUIRED BEFORE THE 3-COURSING IS STARTED

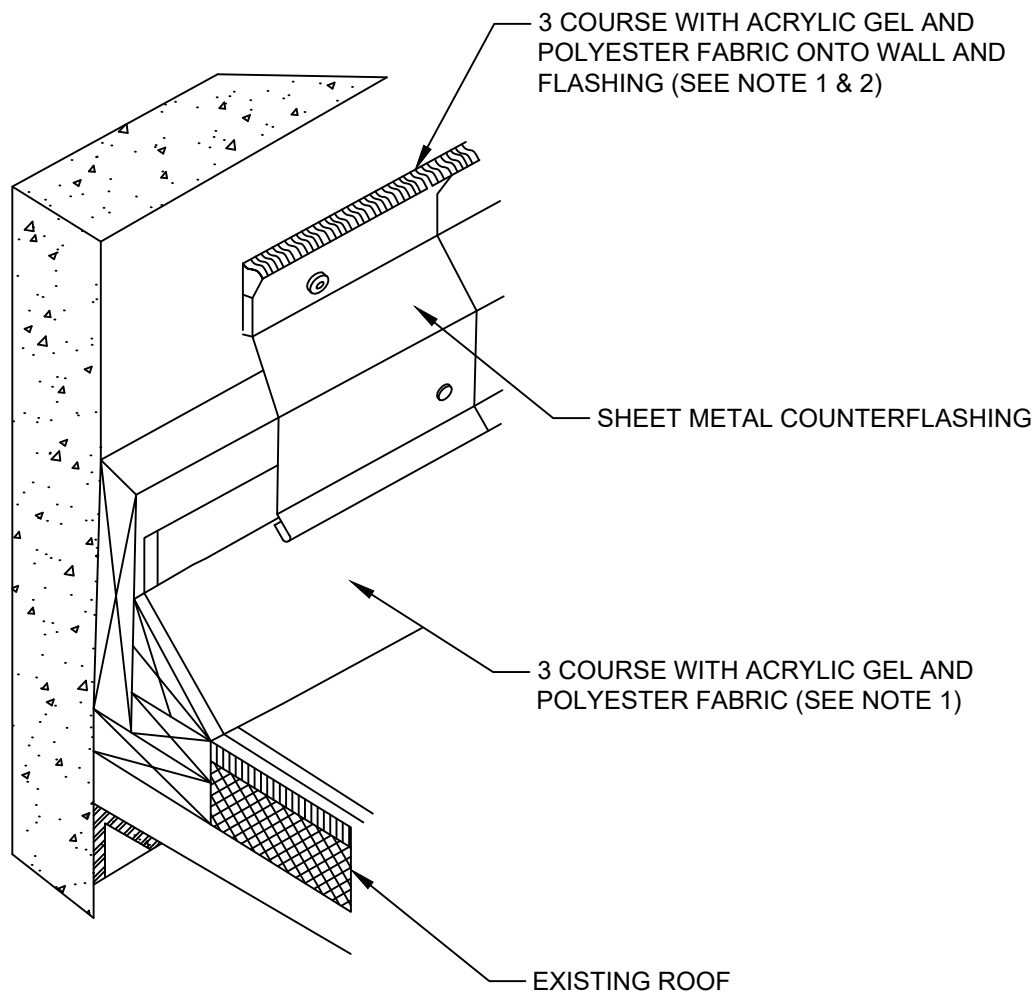

ACRYLIC  
ROOF  
DETAILS

SEAL:

REV:

JOB NUMBER:

SCALE:

DATE: 09-25-17

DRAWN BY: DHALSELL

CHECKED BY:

SHEET:

A-09

# BASE FLASHING WITH COUNTER FLASHING

**NOTES:**

1. THE PRIMER APPLICATION IS REQUIRED BEFORE THE 3-COURSING IS STARTED
2. TOP OF THE FLASHING NEEDS TO BE SEALED TO WALL

OPTION 1 - 3 COURSE WITH ACRYLIC GEL AND POLYESTER FABRIC OVER PERIMETER EDGE (SEE NOTE 1)

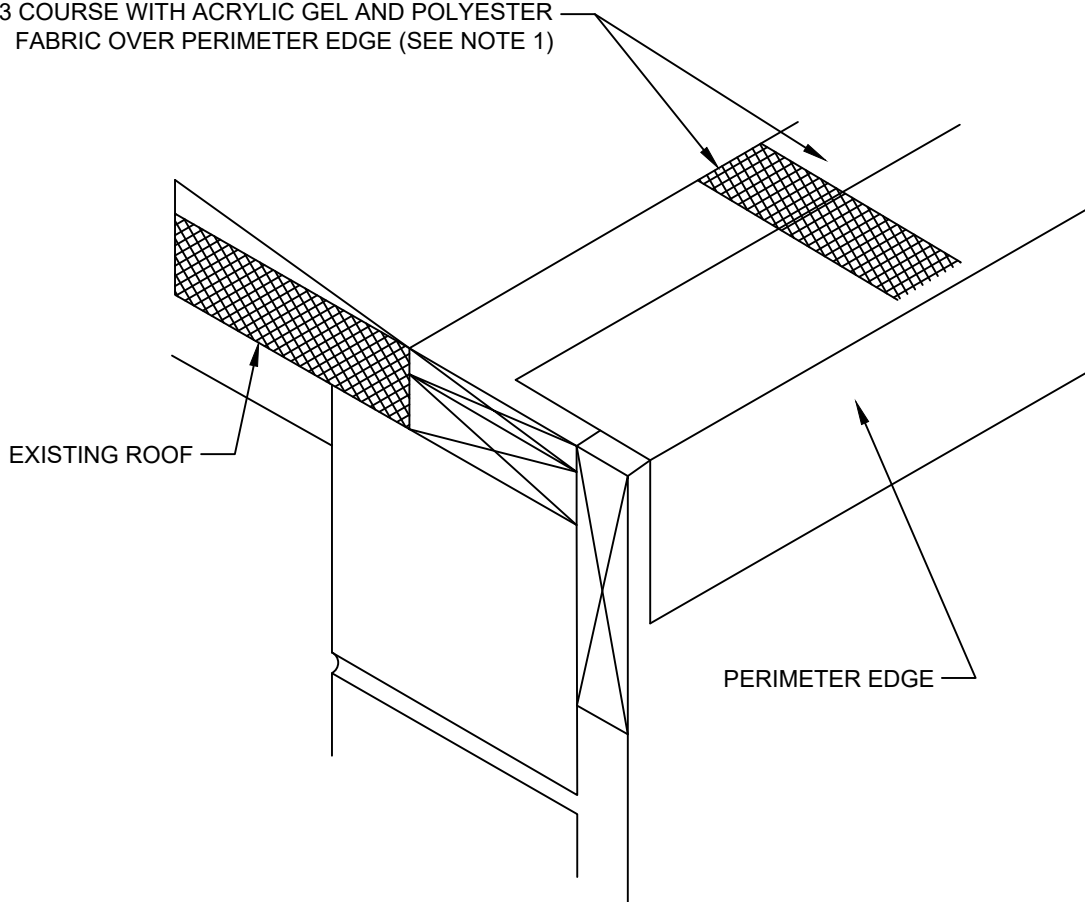

**ACRYLIC  
ROOF  
DETAILS**

SEAL:

REV:

JOB NUMBER:

SCALE:

DATE: 09-25-17

DRAWN BY: DHALSELL

CHECKED BY:

SHEET:  
**A-10**

# ROOF PERIMETER EDGE

**NOTES:**

1. THE PRIMER APPLICATION IS REQUIRED BEFORE THE 3-COURSING IS STARTED
2. NEW METAL DRIP EDGE OR PARAMETER FLASHING NEEDS TO BE TREATED WITH EITHER VINEGAR OR A PRODUCT THAT WILL REMOVE THE OILY RESIDUE BEFORE PROCEEDING TO APPLY COATING PRODUCTS OVER THE NEW OILY SURFACE.

**ACRYLIC  
ROOF  
DETAILS**

SEAL:

REV:

JOB NUMBER:

SCALE:

DATE: 09-25-17

DRAWN BY:  
DHALSELL

CHECKED BY:

SHEET:  
**A-11**

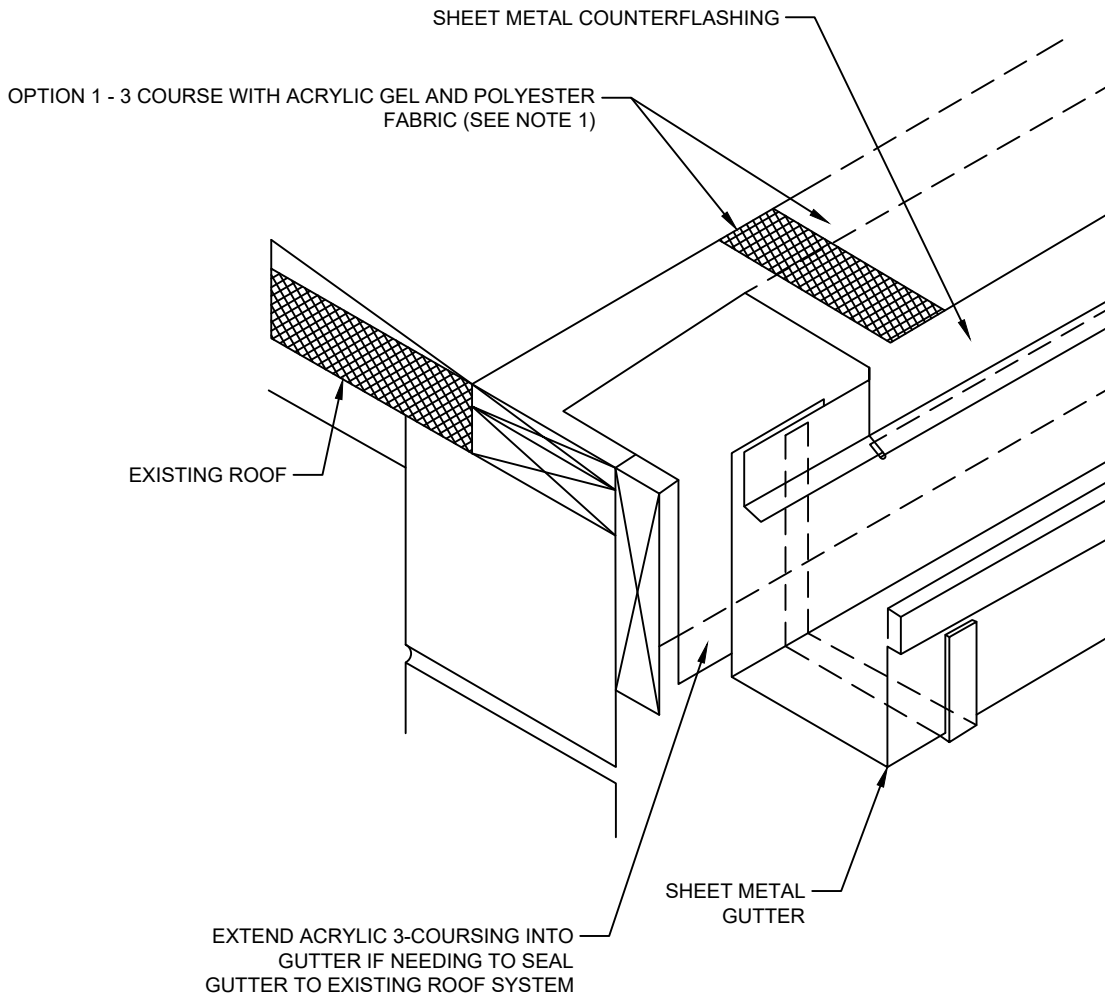

**GUTTER**

**NOTES:**

1. THE PRIMER APPLICATION IS REQUIRED BEFORE THE 3-COURSING IS STARTED
2. NEW METAL DRIP EDGE OR PARAMETER FLASHING NEEDS TO BE TREATED WITH EITHER VINEGAR OR A PRODUCT THAT WILL REMOVE THE OILY RESIDUE BEFORE PROCEEDING TO APPLY COATING PRODUCTS OVER THE NEW METAL SURFACE.

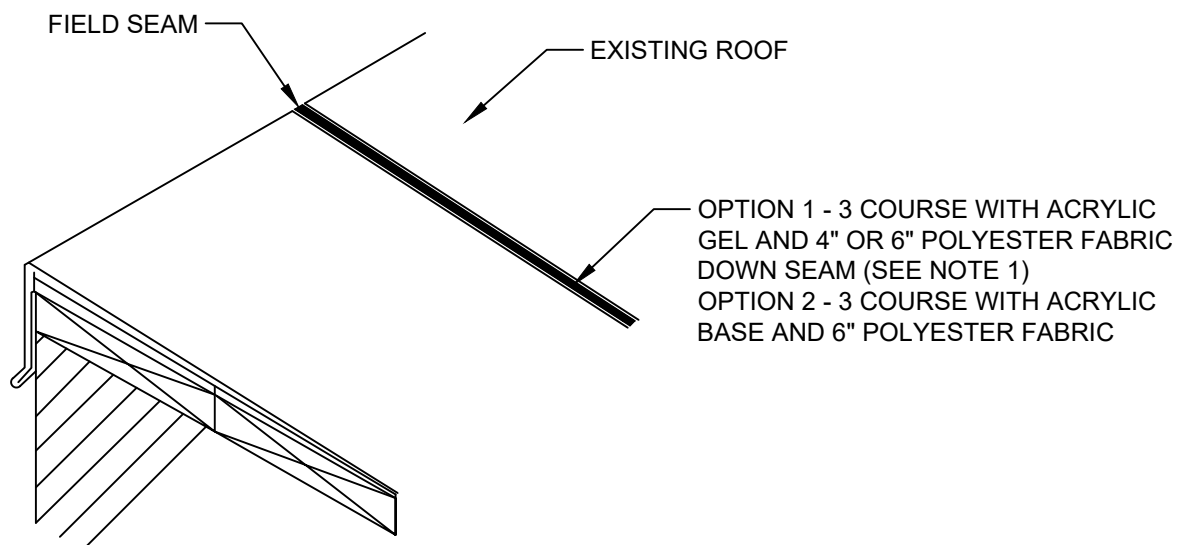

**ACRYLIC  
ROOF  
DETAILS**

SEAL:

REV:

JOB NUMBER:

SCALE:

DATE: 09-25-17

DRAWN BY:  
DHALSELL

CHECKED BY:

SHEET:  
**A-12**

# FIELD SEAMS

**NOTES:**

1. THE PRIMER APPLICATION IS REQUIRED BEFORE THE 3-COURSING IS STARTED
2. 3-COURSING WITH EITHER ACRYLIC GEL OR ACRYLIC BASE AND FABRIC IS AN OPTION TO TREAT AN ENTIRE FIELD SEAM OR JUST TO REPAIR A DAMAGED FIELD SEAM.